

# NORITSU

## QSS-37HD SERIES

QSS-3701HD / 3702HD / 3703HD / 3704HD / 3705HD

		QSS-3701HD	QSS-3702HD	QSS-3703HD	QSS-3704HD	QSS-3705HD
Film types	LS-600 / 1100, HS-1800	Color negative and positive, B&W negative	←	←	←	←
Film formats	LS-600 / 1100	135F, 135H, 135P, 135FP, 135FPP, IX240	←	←	←	←
	HS-1800	110, 135F, 135H, 135P, 135FP, 135FPP, IX240, 6x4.5, 6x6, 6x7, 6x8, 6x9	←	←	←	←
Compatible input media <sup>1</sup>	Standard	HDD, CD-ROM, CD-R, CD-RW, DVD-ROM, DVD-R, DVD+R, DVD+RW, DVD-RW, DVD-RAM	←	←	←	←
	Option	Microdrive, CompactFlash, SmartMedia, SD Card, MMC, RS-MMC, Mini SD Card, Memory Stick, Memory Stick Pro, Memory Stick Duo, Memory Stick Pro Duo, xD-Picture Card, USB Flash Memory	←	←	←	←
Compatible output media <sup>1</sup>	Standard	HDD, CD-R, CD-RW, DVD-RAM	←	←	←	←
	Option	DVD-R, Microdrive, CompactFlash, SmartMedia, SD Card, MMC, RS-MMC, Mini SD Card, Memory Stick, Memory Stick Pro, Memory Stick Duo, Memory Stick Pro Duo, xD-Picture Card, USB Flash Memory	←	←	←	←
Print sizes	Paper width	82.5, 89, 102, 114, 117, 120, 127, 130, 152, 165, 178, 203, 210, 216, 240, 254, 279, 305 (mm)	←	←	←	←
	Paper advance length	Minimum: 82.5mm Maximum: 457.2mm when the width is 82.5 to 120mm / 914.4 when the width is 127 to 305mm	←	←	←	←
Exposure system		Laser exposure system	←	←	←	←
Print resolution		640dpi x 640dpi	←	←	←	←
Film scanning method (LS-600/1100, HS-1800)		Main scanning: Independent line exposure via 3 line CCD Sub scanning: Film movement	←	←	←	←
Paper supply		Dual magazine system (Standard) / Triple magazine system (Factory option) / Quad magazine system (Factory option)	←	←	←	←
Order classification		14 orders / 17 orders	←	←	8/14/17 order	4/17 order
Dimensions		See "External View" below	←	←	←	←
Rated power capacity		AC200V 1P2W 5.0KVA (25A)	←	←	AC200V 1P2W 6.1KVA (31A)	←
Weight	Scanner (LS-600/LS-1100/HS-1800)	LS-600: Approx. 16.7kg / LS-1100: Approx. 17.5kg / HS-1800: Approx. 18.6kg	←	←	←	←
	Printer-Processor (Standard specification)	Approx. 539.4kg	Approx. 539.4kg	Approx. 546.4kg	Approx. 605.1kg	Approx. 570.7kg
Estimated processing capacity (prints/hr) <sup>4</sup> ( ) represents capacity when using high-specification PC. High-spec PC used for QSS-3704HD/3705HD capacities.						
135 negative film (24 exp.)	W127 x 89mm	LS-600	Approx. 600	Approx. 600	Approx. 600	Approx. 600
		LS-1100	Approx. 900	Approx. 1200	Approx. 1200	Approx. 1200
		HS-1800	Approx. 900	Approx. 1310	Approx. 1600 (Approx. 1650)	Approx. 2200
	W152 x 102mm	LS-600	Approx. 600	Approx. 600	Approx. 600	Approx. 600
		LS-1100	Approx. 900	Approx. 1180	Approx. 1200	Approx. 1200
		HS-1800	Approx. 900	Approx. 1180	Approx. 1480	Approx. 2000
	W203 x 254mm	LS-600	Approx. 190	Approx. 270	Approx. 350	Approx. 380
		LS-1100	Approx. 190	Approx. 270	Approx. 350	Approx. 510
		HS-1800	Approx. 190	Approx. 270	Approx. 350	Approx. 510
	W305 x 457mm	LS-600	Approx. 110	Approx. 130 (Approx. 160)	Approx. 130 (Approx. 200)	Approx. 220
		LS-1100	Approx. 110	Approx. 130 (Approx. 160)	Approx. 130 (Approx. 200)	Approx. 290
		HS-1800	Approx. 110	Approx. 150 (Approx. 160)	Approx. 150 (Approx. 200)	Approx. 240
Repeat printing	W127 x 89mm	Approx. 900	Approx. 1310	Approx. 1650	Approx. 2250	
	W152 x 102mm	Approx. 900	Approx. 1180	Approx. 1480	Approx. 2120	
	W203 x 254mm	Approx. 190	Approx. 270	Approx. 350	Approx. 510	
	W305 x 457mm	Approx. 110	Approx. 160	Approx. 200	Approx. 290	
Digital camera (4 megapixels) <sup>2</sup> excluding raw images	W127 x 89mm	Approx. 900	Approx. 1310	Approx. 1650	Approx. 2250	
	W152 x 102mm	Approx. 900	Approx. 1180	Approx. 1480	Approx. 2120	
	W203 x 254mm	Approx. 190	Approx. 270	Approx. 350	Approx. 510	
	W305 x 457mm	Approx. 110	Approx. 160	Approx. 200	Approx. 290	
Digital camera (6 megapixels) <sup>3</sup> excluding raw images	W127 x 89mm	Approx. 900	Approx. 1310	Approx. 1500 (Approx. 1650)	Approx. 2000	
	W152 x 102mm	Approx. 900	Approx. 1180	Approx. 1400 (Approx. 1480)	Approx. 2000	
	W203 x 254mm	Approx. 190	Approx. 270	Approx. 350	Approx. 510	
	W305 x 457mm	Approx. 110	Approx. 160	Approx. 200	Approx. 290	

<sup>1</sup> Depends on the PC, card reader used. Indicates image formats supported when using the computer system supplied by Noritsu Koki.  
<sup>2</sup> Using 512MB xD Picture Card. 2304 x 1728 pixels per image.  
<sup>3</sup> Using 512MB xD Picture Card. 3024 x 2016 pixels per image.  
<sup>4</sup> EZ Controller image output setting: 320 dpi / 8 bit.  
 Calculated according to our criteria. The actual capacity you achieve may be different.



State-of-the-art digital minilabs with a name that embodies our confidence in high definition and high resolution prints

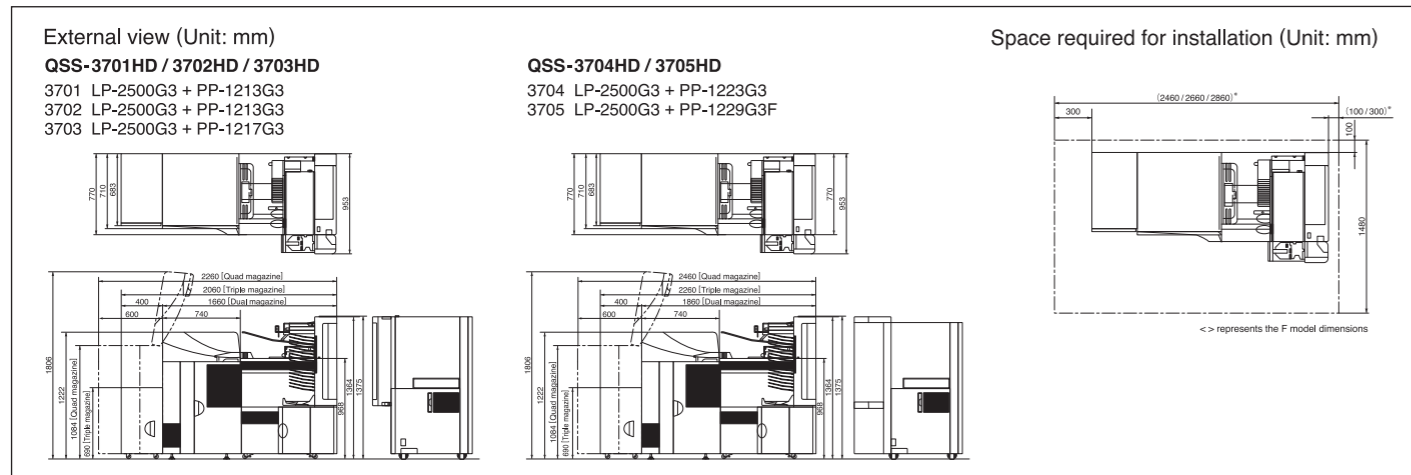

**NORITSU KOKI CO., LTD.**

The specifications, information, and appearance of the machines herein are subject to change without notice.

**TUV** Our products have been manufactured under an ISO 9001-certified quality assurance system.

579-1 UMEHARA, WAKAYAMA-SHI, 640-8550, JAPAN  
 PHONE: (81) 73-454-0345 FACSIMILE: (81) 73-454-0301  
 http://www.noritsu.co.jp

**COUNTRY OFFICE**  
 Australia Noritsu Koki Australia Pty. Ltd.  
 Brazil Noritsu Do Brasil Ltda.  
 Canada Noritsu Canada Ltd.  
 The Czech Rep. Noritsu (CR) spol. sr. o.  
 China Noritsu (Shanghai) P. E. M. Co., Ltd.  
 France Noritsu France E. U. R. L.  
 Greece Noritsu Hellas Ltd.  
 Germany Noritsu (Deutschland) GmbH  
 Hong Kong Noritsu (Far East) Ltd.  
 India Noritsu India Branch  
 Italy Noritsu Italia S. r. l.

**PHONE NO.**  
 (61) 2-9317-2141  
 (55) 92-3615-4300  
 (1) 905-567-8982  
 (420) 241-040901  
 (86) 21-5046-3997  
 (33) 1-57-02-12-90  
 (30) 210-6019506  
 (49) 2154-9157-0  
 (852) 2873-4788  
 (91) 11-41427245  
 (39) 0321-445211

**COUNTRY OFFICE**  
 Malaysia Noritsu Koki Malaysia Sdn. Bhd.  
 Mexico Noritsu Mexico S.A. De C.V.  
 The Philippines Noritsu Philippines, Inc.  
 Poland Noritsu (Poland) Sp. z.o.o.  
 South Korea Noritsu Seoul Branch  
 Russia Noritsu (R) Ltd.  
 Singapore Noritsu Singapore Pte. Ltd.  
 Taiwan Noritsu Taiwan Co., Ltd.  
 U. A. E. Noritsu Near East Branch  
 U. K. Noritsu (UK) Limited  
 U. S. A. Noritsu America Corporation

**PHONE NO.**  
 (60) 3-78762733  
 (52) 55-2626-6710  
 (63) 2-812-8443  
 (48) 22-863-2800  
 (82) 2-569-2701  
 (7) 495-933-6446  
 (65) 6778-8333  
 (886) 2-2508-1908  
 (971) 4-8837556  
 (44) 1908-371100  
 (1) 714-521-9040

**PHONE NO.**  
 (60) 3-78762733  
 (52) 55-2626-6710  
 (63) 2-812-8443  
 (48) 22-863-2800  
 (82) 2-569-2701  
 (7) 495-933-6446  
 (65) 6778-8333  
 (886) 2-2508-1908  
 (971) 4-8837556  
 (44) 1908-371100  
 (1) 714-521-9040

**NORITSU, QSS** and **AccuSmart** are trademarks of Noritsu Koki Co., Ltd.  
 "Memory Stick" is a trademark of Sony Corporation.  
 All other product and company names herein may be trademarks of their respective owners.



# The QSS-37HD ushers in a new era

## A REVOLUTION IN PHOTOGRAPHS

The desire to preserve a special memory as a photographic print. This desire has been around since the dawn of photography. To fulfill this basic desire, Noritsu Koki has endeavored to achieve the goal of providing optimal photographic portrayal, and we have continually enhanced the technology that enables high quality photos. However, recently we can detect a subtle change in this seemingly unchanging desire. Many photo-enthusiasts now want to go a step beyond that simple high quality photo. They are now seeking a special shot that has even better quality than before. When you take advantage of the benefits of digital processing and use careful calculations to print the images, you get consistent print quality across the board. However photographs are no longer considered to have value just as a record of our memories, they also are now considered to be an expression of our individuality and our emotions. We developed the QSS-37HD series with this new era as a background, providing higher resolution, higher definition and more creative portrayal than ever before. Our minilab has evolved to meet the new demands. Come experience the QSS-37HD difference.

**Everyone has different photo needs.**

**To fulfill your needs for optimal quality, we bring you a system that boasts high resolution and high definition.**

As high-end digital cameras are becoming more prevalent, the expectations for prints are higher and more complex. Noritsu Koki knows that the only way to meet the individual print needs is to enhance the specifications of the printer. This is why we have improved the laser exposure system, resulting in higher resolution, higher quality prints. We bring you a system that provides the exact image quality you are aiming for, and covers a diverse range of needs. Come discover the awesome image potential of the amazing QSS-37HD series.







# A revolution in beauty

The pursuit of beauty may seem like chasing an intangible and unattainable dream.

Photographic beauty is subject to the limitations of the camera and the photography techniques,

and the criteria for labeling something beautiful also varies from person to person since beauty is indeed in the eyes of the beholder.

Therefore, fulfilling Noritsu Koki's mission of delivering beautiful photos to customers everywhere all the time is very difficult,

to say the least. But the QSS-37HD series has enabled us to take a giant step forward in this regard. The laser engine,

which is regarded as the heart of the printer, has been improved so as to attain an even higher level of quality.

The user-friendly image processing operation and all the other special features of the QSS-37HD work together to provide

high quality photographs that satisfy all customers, regardless of their individual tastes.

*A revolution in beauty – This is what the QSS-37HD will bring.* This printer will change your dreams into reality.

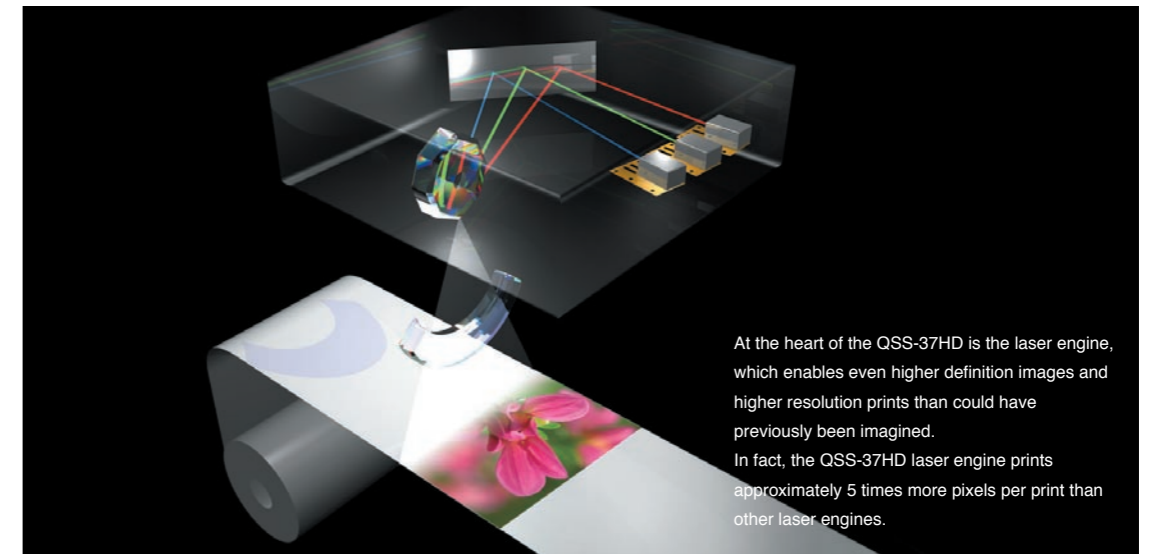

At the heart of the QSS-37HD is the laser engine, which enables even higher definition images and higher resolution prints than could have previously been imagined. In fact, the QSS-37HD laser engine prints approximately 5 times more pixels per print than other laser engines.

## High resolution enables high quality prints with sharp portrayal of fine details

It is resolution that is vital in producing realistic looking photos, as is the case with photographs that accurately portray the scene that the photographer views when he peers through his lens. Pursuing resolution is our mission here at Noritsu Koki, and it is an area we continue to make rapid progress in. The QSS-37HD series consists of minilabs that are worthy of the letters they bear - "HD" (for High Definition). With a name that embodies our confidence, we bring you the QSS-37HD series and a new meaning to the word "high quality".

## An amazing resolution of 640 dpi (12 bits). This translates to 79 million pixels for an A3 size print

Having a printer that produces prints of silver halide quality provides a big advantage for the photo retailer. For icing on the cake, the QSS-37HD has a newly developed laser engine that has an unprecedented resolution of 640 dpi for both main scanning and sub scanning, and this results in prints with 5 times more pixels than prints made with previous minilabs. All these extra pixels result in finely detailed prints that have a dimension that is not available with other printers.

## Raw image data processed automatically



Up to now, handling raw image data has been a troublesome affair. To solve this problem, Noritsu Koki has formed a technical cooperation agreement with Adobe Systems. According to this agreement, raw image conversion software is incorporated in the EZ Controller, and raw image files are converted to the DNG file format, and then the images are enhanced with Noritsu Koki's "AccuSmart" image processing technology. Utilizing the technology made available in this agreement, Noritsu Koki developed a system that produces optimal prints automatically, undergoing the same basic process as when making prints from film images. This means you do not have to do anything special to print raw image data. These orders can be processed just like any other print order.

### JPEG data      Raw data



A large portion of the pixel data in the original JPEG image has highlight areas that are too light. When the image is corrected, the overall light in the image is reduced, but the pixels representing the highlight areas that were too light are unsalvageable.

All gradations are used, producing an image that is balanced well. There are very few pixels with shadows that are too dark and highlights that are too light.

### 300 dpi (8 bits)

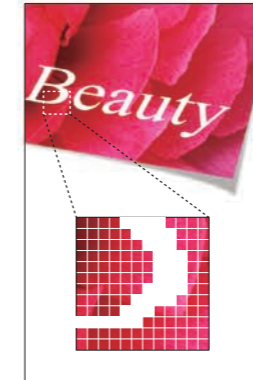

### 640 dpi (12 bits)

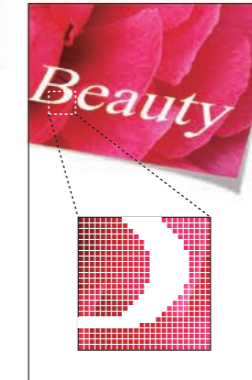

## The QSS-37HD series delivers high quality prints in a flash



Digital camera image data and image data scanned from film is easily corrected to produce beautiful photos that closely resemble what the photographer sees when he snaps the shutter. For example, Digital ICE and Digital Masking are used to automatically correct dust and scratches on film, and you can set values for insufficient peripheral light, color aberration, and distortion, and make unrestricted correction of lens aberration. With the QSS-37HD series, it is easy to provide consistent quality without undergoing any complicated procedures.



# A revolution in versatility

Photographs are a wonderful form of entertainment.

We at Noritsu Koki believe this with all our heart.

We see many people pick shots that are special to them and preserve them in ways that enrich their lives. Noritsu Koki cherishes such scenes, and we want to enhance the enjoyment of photographs through our machines.

The QSS-37HD was developed under our certified product development system, which is constantly striving for improvement and is always aiming to develop versatile machines that go beyond the present market needs.

We hope that you will take advantage of all that our machines have to offer, and use them to build an exciting shop. Doing so will fuel your customers' interest in photographs, and this in turn will lead to customer growth and an increase in revenue.

***A revolution in versatility – This is what the QSS-37HD will bring.***

This printer will exceed your expectations and set you apart from the competition.



## Consumers can operate the CT terminal themselves and thereby gain a first-hand appreciation of the joy of making prints

Installing CT digital media input terminals will not only enable your customers to discover the joy of selecting the photos they want to print, this also enhances efficiency by eliminating order-taking hassle for the employees. The CT terminal's intuitive interface, easy-to-use GUI, and exciting templates make it fun and easy to use.



It is important to set up chairs in the CT area and create an environment where your customers can come in and relax. Another important thing to do is set up dividers between the terminals to protect the privacy of the users.

Can input raw image data.

## “Color Tone Selection” is a fun service that provides an alternative look

Nowadays, many people are looking for a way to give a creative look to their photos, and many customers want to choose the color tone for their photos. In addition to the basic color tone, it is also possible to choose other unique color tones with the QSS-37HD, including “Vivid”, “Nostalgic”, and “High Key” which creates a pleasant scene with a pale color tone.



Vivid



Nostalgic



High Key

## The QSS-37HD series provides many ways for your customers to enjoy their photos, and it creates countless photo opportunities

We are now seeing a lot of variation in value-added photos and personalized photo products, thanks to the versatility of digital image data. You can make many different kinds of albums and many different kinds of prints in various sizes up to 12 x 36 inches. Letting your customers know about the extensive variety of print services available at your shop is a great way to expand your business possibilities. This is sure to help you pull in new customers, and reinforce the customer base you already have. You can surprise your customers by offering new services they never thought possible, and the high-performance QSS-37HD series provides the ideal environment for doing this.

## The multi-function EZ Controller (sold separately) is a powerful asset that improves efficiency

The EZ Controller takes care of everything from print order management to color correction of the individual images. It can be installed in networked computers, providing a flexible system in which image editing can be carried out efficiently with multiple computers.



“Easy Operation” Order Display



PJP Display

## Film scanners to meet the needs of film users

We have three different scanners to choose from, enabling you to provide a high-quality print solution to film users.

Scanning capacity (135F) \*1

**LS-600**\*2  
(1002×1512 pixels) **600** frames/hr

**LS-1100**\*2  
(1002×1512 pixels) **1,200** frames/hr

**HS-1800**  
(1037×1565 pixels) **1,600** (2,200)\*3 frames/hr

\*1 The print capacity varies according to the printer-processor used.

\*2 135/1X240 only. No carrier required.

\*3 Using high-spec PC.



HS-1800



Jumbo Panorama Prints

Design Albums



# A revolution in speed

Speed provides a big advantage in the photo business. Speed improves productivity and is tied directly to customer satisfaction and profitability.

Being this as it may, Noritsu Koki's stance is that it is in no way acceptable to sacrifice quality for speed. To this end, we have undertaken the next-to-impossible task of maintaining high precision while improving the processing capacity.

We use synergy to incorporate excellent features into our latest high-quality high-speed printers, and we do our best to provide a smooth workflow.

This is the main reason so many people around the world support us and our products.

***A revolution in speed – This is what the QSS-37HD will bring.***

This new minilab will change your perspective.



## Choose a capacity that meets your needs

It is an unmistakable fact that print capacity is the key to providing a smooth photo business, and Noritsu Koki has continually strived to provide higher capacities so retailers can meet a wide range of processing demands, including sudden orders for large print volumes. However, it is also true that required capacities vary with the business scale. Printing the quantity you need, when you need it. The fact that our minilabs answer those needs makes them versatile machines. The QSS-37HD series has 5 different capacities to choose from. In addition to the choice of capacities, these printers allow for smooth high-speed processing during peak times as well as slower times, and the same consistent high quality photos are provided at all times.

<b>QSS-370IHD</b> Approx. <b>900</b> prints/hr	<b>QSS-3702HD</b> Approx. <b>1,180</b> prints/hr	<b>QSS-3703HD</b> Approx. <b>1,480</b> prints/hr
<b>QSS-3704HD</b> Approx. <b>2,120</b> prints/hr	<b>QSS-3705HD</b> Approx. <b>2,360</b> prints/hr	

Repeat printing. W152x102mm (W6"x4").  
Calculated according to our criteria. The actual capacity you achieve may be different.

## Automatic functions

### ■ Auto daily setup

Daily setup is carried out automatically using the program timer. This reduces the prep time required before business hours, helping you to reduce labor fees and use your time more efficiently.

### ■ Colorimeter

The colorimeter is built into the processor. During setup, the setup print is automatically fed into the colorimeter as it comes out of the dryer.



Colorimeter

## Triple magazines / Quad magazines Factory option

Replacing magazines every time you need to change print sizes can be a time-consuming task. But you can eliminate the need for frequent magazine changes by loading 3 magazines with the triple magazine system or even 4 magazines with the quad magazine system.



Triple magazines



Quad magazines

## On-the-spot prints for a one-stop service

Keeping in line with current trends, many photo shops are placing more emphasis on speed for their print services. A standard QSS-37HD printer provides ample speed as it is, but it is also possible to hasten the print speed even further. Installing CT input terminals will greatly enhance your digital input workflow, using the EZ Controller will provide an efficient print workflow, and "rapid processing chemicals" will bring a reduction in the processing cycle, while at the same time enabling easy and safe "one touch" replacement. These three powerful tools enable an on-the-spot print service where the print orders are fulfilled in minutes. This means customers can come into your shop, place the order, and pick up the prints in the same visit. This ability is sure to help you attract new customers who have not printed at retail in the past due to personal time restraints.

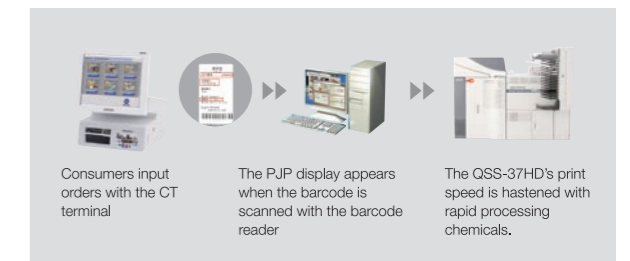

Consumers input orders with the CT terminal

The PJP display appears when the barcode is scanned with the barcode reader

The QSS-37HD's print speed is hastened with rapid processing chemicals.

## Control Strip Auto Loading Unit Option

Constantly checking the conditions of the chemicals can be a troublesome affair, but the convenient Control Strip Auto Loading Unit makes this an easy task. All you have to do is set the control strip in the Auto Loading Holder Unit without a leader and set this unit in the processor. This enables the control strip to be processed automatically when processing begins.



Control Strip Auto Loading Unit

## Display module Option

The Display Module displays error messages and other vital information, and this enables you to confirm the condition of the printer, even if it is separated from the EZ Controller. This way you will be aware of the condition of the printer at all times, even when you are busy attending to customers, and this will enable you to quickly recognize and solve any problems that may arise.



Display module



# A versatile network system that supports a variety of shop needs



## Independent shops / Chain stores

Automation from input to output, which is beneficial for a small-scale staff.

Orders input with the CT terminal are controlled with the EZ Controller. These images are printed after being corrected. You can support film users by connecting a scanner. With the ability to provide on-the-spot prints and other convenient services, Noritsu Koki provides an efficient workflow for small-scale shops.

### A seamless workflow from order placing to printing

— LAN — USB



### Can support film users by adding a scanner

— LAN — USB

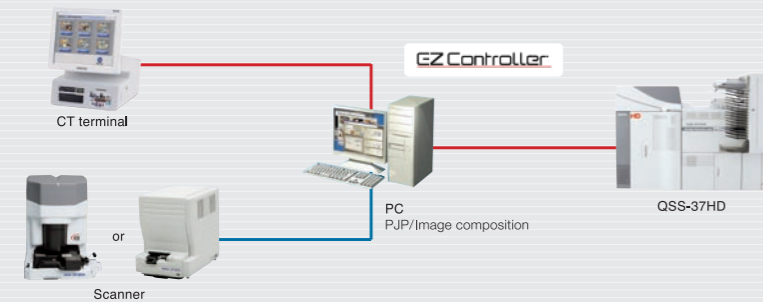

## Photo studios

Smooth operations for studios that rely heavily on image correction

Using a separately placed computer, it is possible to perform image editing in a separate area. If you install the QSS Printer Driver software in the computer, used to using. This provides smooth operations for photo studios that perform a large amount of image correction.

### Process images and print them right away with a LAN connection

— LAN — USB

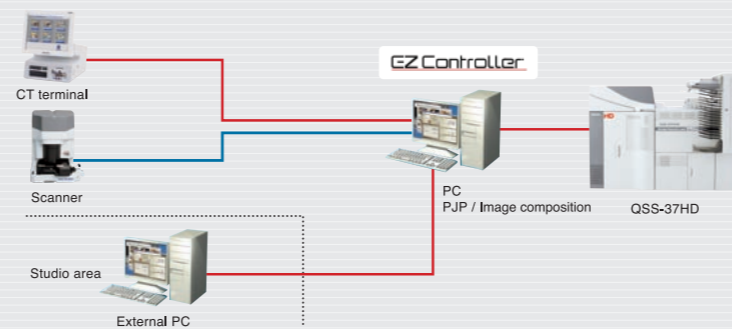

### Print from your favorite applications using the QSS Printer Driver

— LAN — USB

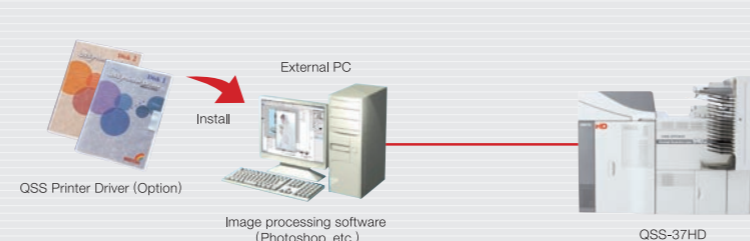

## Pro labs

Can process large volumes smoothly with a scalable network system

In addition to making prints, this flexible network system enables you to scan film and process the images on a computer, burn CDs, install the EZ Controller in multiple computers, and boost your productivity by configuring your network so particular orders are distributed to specified printers. If you construct your network to enable third party software to be used, you can connect the optional NetOrder Converter, which also makes it possible to support Internet orders. As you can see, it is possible to support diverse business styles when you use Noritsu equipment.

### Smooth fulfillment of diverse orders, taking full advantage of your equipment

— LAN — USB

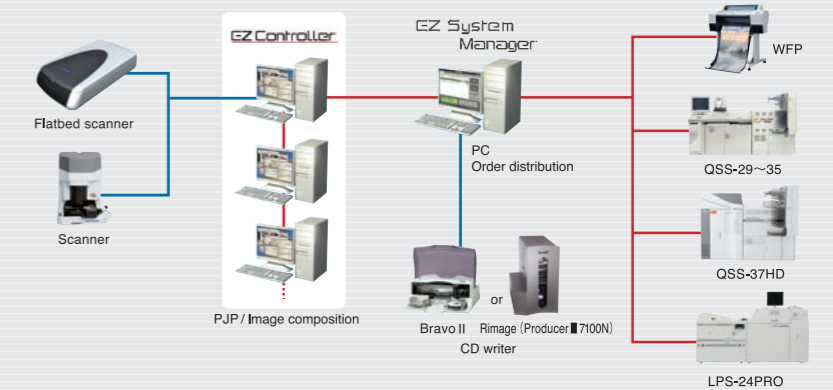

### Can receive orders from other stores via the Internet

— LAN — USB

