

NORITSU

DIGITAL INNOVATIONS AND CREATIVE SOLUTIONS

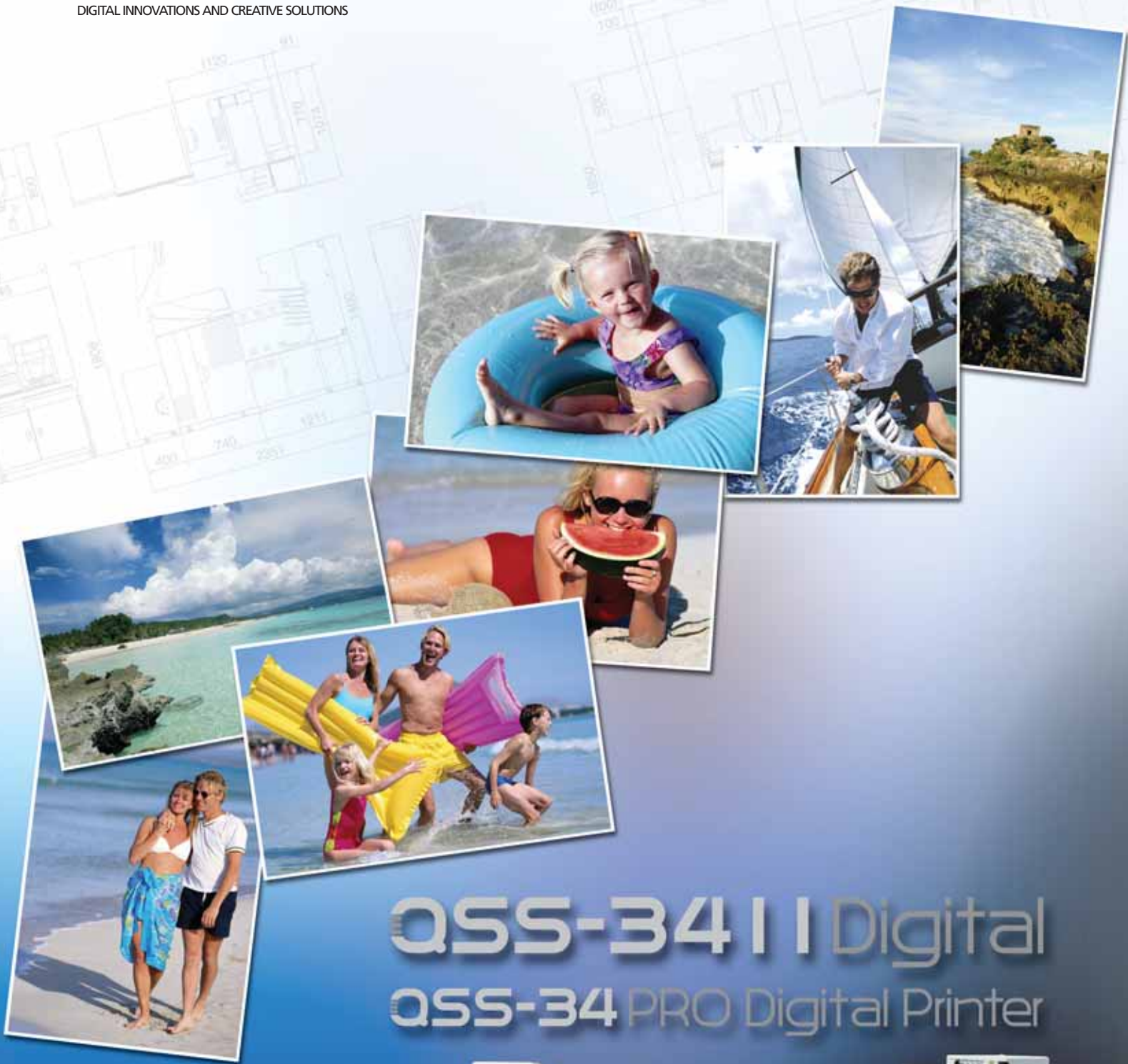

QSS-3411 Digital QSS-34 PRO Digital Printer



QSS-3411 Digital

QSS-34 PRO Digital Printer

The QSS-3411 Digital and QSS-34 PRO offer reliability, speed and efficiency. When maximum productivity and performance are required, these powerful digital printers deliver.



HIGH-SPEED PRINTING
2,000 prints / hr
(4" x 6")

HIGH-QUALITY
300 dpi

MAXIMUM PRINT SIZE
12 x 36 inches

High-quality prints with image optimization technology

The QSS-34 Series features built-in image correction technology that automatically adjusts to ensure consistent, high-quality prints. Additional optional image correction functions are also available.



Unique features exclusive to Noritsu

Prints up to 12" x 36" Jumbo Panorama

The QSS-3411 has the capacity to print up to 12"x 36" jumbo panorama prints. With the QSS-34 Series, new revenue opportunities such as point-of-purchase displays, calendars and other larger format output are now yours.



Print Tiling

Tiling enables you to divide a large image into multiple sections and print them on smaller pieces of paper, which can be placed together to make a photo that exceeds the printer's maximum print size.

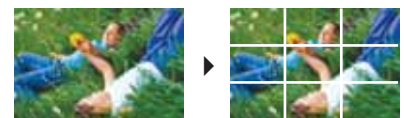

Powerful Image Correction Software Included

The QSS-3411 Digital minilab has a number of robust features for correcting a variety of image imperfections. This built-in software enables you to provide great-looking prints, even if the image source is flawed.

DIGITAL ICE™

DIGITAL ICE automatically discovers and corrects dust and scratches on the base layer of film. This convenient feature optimizes and restores each image into beautiful, blemish-free prints.



DIGITAL ICE is a trademark of Eastman Kodak.



Original Image

DIGITAL ICE

Digital Masking

JPEG Block Noise Correction

Smooths blocking that occurs during image compression.



Lens Aberration

Corrects distortion, chromatic abnormalities and insufficient brightness in the edge of the image field.



Red Eye Correction

Red eye is automatically detected and can be fixed automatically or manually.



Optional Image Correction Software Modules

Expand your image enhancement capabilities on the QSS-3411 Digital with optional filters that can produce unique and exciting results.

Digital Masking Software

Noritsu's Digital Masking software automatically corrects dust and scratches on the emulsion layer of film when DIGITAL ICE is unable to correct.

Cross Filter

Cross marks are placed in areas of shining or reflecting light, adding a dramatic accent to images.



Soft Filter

This filter softens images with a distinctive, fog-like effect.



Tone Curve Correction

Precise tone adjustments are made for each individual color channel (RGB).



STREAMLINED WORKFLOW

INPUT

QSS-3411 & QSS-34 PRO Sold Separately

Digital Media



CT-2MD
Noritsu
Consumer Terminal

Digital Camera Media



d-Storage
Scanned image data can be saved as JPEG files and stored on a networked PC. Archived d-Storage images can be edited or corrected without affecting performance of the QSS-34 Series minilab.



Film



Noritsu QSS Printer Driver



QSS-Kids
(optional)

This software allows you to perform most of the same operations as the QSS-3400 Series on an external computer.

8" x 10" PRINTS
500 / hour



Bravo II™
(optional)



The QSS-3400 is network ready and is compatible with various external CD-R writing equipment.

Rimage™
(optional)



A variety of features available to meet your needs

Quad Paper Magazine (optional)

A new industry first – a quad paper magazine is an available option on the QSS-3411. You can now print various sizes without stopping to change magazines. For greater convenience and versatility, add an optional quad paper magazine system and watch your productivity soar.

NEW!

**QUAD PAPER
MAGAZINE**

Reduced Processing Time (optional)

Your QSS-3411 Digital minilab can be modified to reduce the print processing time when specified chemicals are used.



Triple Magazine System (optional)

Enables you to set additional paper sizes and increase the variety of print sizes that can be made without changing magazines.

Film Carriers (optional)

There is a wide range of film carriers available, such as 135, IX240, 120 and 110 film.





S-34 PRO



QSS-3411 Digital

Silver Halide Prints

Additional Value Prints:
Photo Template Cards,
I.D. Cards, etc.Saving Data
in d-StorageMedia Writing from
Film, Media or Prints

High-Quality Laser Exposure System (standard)

The heart of the QSS-34 Series is the 300 dpi laser exposure system which provides sharp lines, vivid colors and delicate gradations.

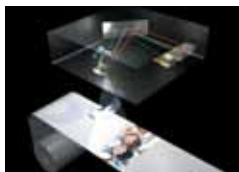

Multi-Paper Matching (standard)

Noritsu's multi-paper matching technology enables all brands of digital paper and conventional photo paper to be used. You'll get high-quality prints with consistent color management, no matter what paper you use.

Multi Drive Unit (standard)

The Multi Drive Unit provides easy-to-locate slots for virtually every type of digital camera media. (An MO drive, Zip drive and other drives are also available as options.)



LED Light Source (QSS-3411 standard)

An LED light source in the QSS-3411 film scanner yields consistent scans and requires minimal maintenance. Scanner not included in QSS-34 PRO model.



Easy Maintenance (standard)

The QSS-34 Series features automatic cleaning of the upper guides in the processor and has easy access to internal parts, which makes maintenance simple.



QSS-34 | Digital

QSS-34 PRO Digital Printer

QSS-3411 DIGITAL/QSS-34 PRO DIGITAL PRINTER SPECIFICATIONS

Film types:	Color negative and positive (including mounted), B&W negative (Chromogenic B&W), Sepia negative
Film size:	110, 135F, 135H, 135P, 135FP, 135FPS, IX240, 6x4.5, 6x6, 6x7, 6x8, 6x9
Compatible input media:	Standard: FD, CD-ROM, CD-R, CD-RW, CompactFlash, Microdrive, SmartMedia, PC Card, CD Card, Mini SD Card, MMC, Memory Stick, Memory Stick Pro, Memory Stick Duo, Memory Stick Pro Duo, xD-Picture Card, USB Flash Memory Optional: MO, ZIP
Compatible output media:	Standard: FD, CD-R, CD-RW, CompactFlash, Microdrive, SmartMedia, PC Card, CD Card, Mini SD Card, MMC, Memory Stick, Memory Stick Pro, Memory Stick Duo, Memory Stick Pro Duo, xD-Picture Card, USB Flash Memory Optional: MO, ZIP
Exposure system:	Laser scanning exposure by paper movement
Print resolution:	300 dpi
Exposure speed:	3 inches/sec.
Print sizes:	Paper width: 3.25, 3.5, 4, 4.5, 4.6, 4.7, 5, 6, 6.5, 7, 8, 8.25, 8.5, 9.5, 10, 11, 12 (inches) Paper advance length: 3.25 to 18 inches (for widths from 3.25 to 7 inches) / 3.25 to 36 inches (for widths from 7.99 to 12 inches)
Display monitor:	17 inch color display monitor
Transport system:	Roller transport
Processing speed:	91 inches/min.
Paper supply:	Triple magazine system (optional), Quad magazine system (optional)
Paper specifications:	Maximum diameter of paper roll: 9.8 inches
Water refilling:	Automatic water refilling
Weight:	Scanner: Approx. 419 lb QSS-34 PRO Digital Printer: Approx. 267 lb (CS-1) Printer-Processor: Approx. 1405 lb/Approx. 1389 lb (SM)

ESTIMATED PROCESSING CAPACITY (PRINTS/HR)

135 negative film (24 exposure):	3.5 x 5 inches:	Approximately 2100
	4 x 6 inches:	Approximately 2000
	8 x 10 inches:	Approximately 500
	12 x 18 inches:	Approximately 290
IX240 negative film (25 exposures):	3.5 inch paper width:	Approximately 1420
	Digital camera*:	3.5 x 5 inches: Approximately 2100
		4 x 6 inches: Approximately 2000
		8 x 10 inches: Approximately 500
	12 x 18 inches:	Approximately 290

*1 : 32MB SmartMedia. 1712 x 1368 pixels per image. JPEG image size: 490KB to 560KB.

All of the capacities (including capacities from film) listed herein do not include index prints. Calculated according to our criteria. The actual capacity you achieve may be different. Specifications subject to change without notice.

QSS-3411 Digital Space required for installation (Unit : Inches)

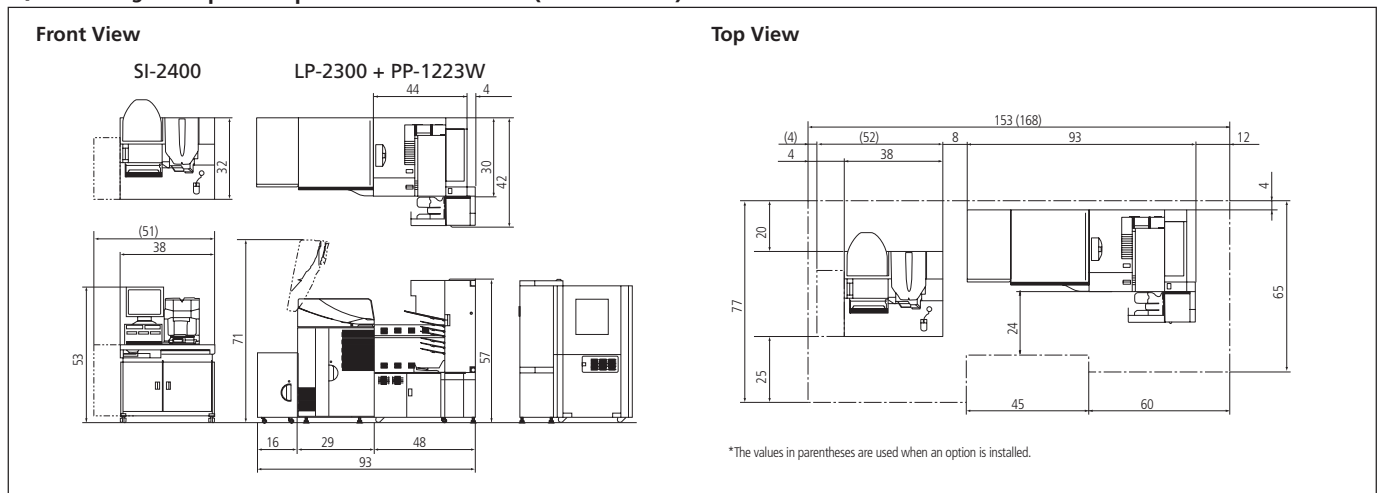

NORITSU

DIGITAL INNOVATIONS AND CREATIVE SOLUTIONS

(800) 521-3686 x 219

www.noritsu.com

Noritsu America Corporation
6900 Noritsu Avenue
Buena Park, California 90620-1372

Western Regional Office
6950 Noritsu Avenue
Buena Park, California 90620-1311

Eastern Regional Office
336 Route 46 East
Fairfield, New Jersey 07004-2429

Midwest Regional Office

775 Tollgate Road
Elgin, Illinois 60123-9301
Southern Regional Office
2989 North Stemmons Freeway
Dallas, Texas 75247-6193

Latin America Regional Office
1800 N. Commerce Parkway, Suite 2
Weston, Florida 33326

Government Sales Office

8000 Towers Crescent Drive, Suite 1350
Tysons Corner, Virginia 22182-2700

Noritsu Canada Ltd.
2680 Argentia Road
Mississauga, Ontario, Canada, L5N 5V4

Noritsu de México S.A. de C.V.
Plaza Mayorazgo de Luyando No. 7
Col. Xoco, Delegación Benito Juárez
C.P. 03330 México, D.F.

CAT#3411B 10/05